

FLOVAGE EASEMENT

APPROXIMATE LOCATION OF 100 FLOOD YEAR FLOOD PLAIN

LAKE CONRDE

LINE	BEARING	DISTANCE
L1	S 25° 52' 57" E	8.73
L2	N 41° 30' 37" E	26.38
L3	N 27° 58' 07" E	36.71
L4	N 10° 59' 47" E	30.51
L5	N 22° 11' 21" E	25.89
L6	N 14° 46' 51" V	26.58
L7	N 64° 06' 06" V	42.10
L8	N 49° 37' 22" V	50.96
L9	N 12° 15' 22" V	21.38
L10	N 58° 01' 46" E	4.45
L11	N 00° 50' 03" E	20.87
L12	S 15° 25' 00" V	22.80
L13	S 15° 25' 00" E	32.97
L14	S 05° 55' 57" E	39.76
L20	N 74° 35' 00" V	30.71
L21	N 22° 11' 21" E	20.80
L22	N 22° 11' 21" E	5.09

RESERVE 'DD' 0.043 ACRES WALNUT COVE SECTION 3

WALNUT COVE SECTION ONE CAB. SHEET 181-A

WARM SPRINGS (50' PRIVATE ROW)

SCARLET OAK (EXISTING 50' PRIVATE ROW)

LAKE CONRDE

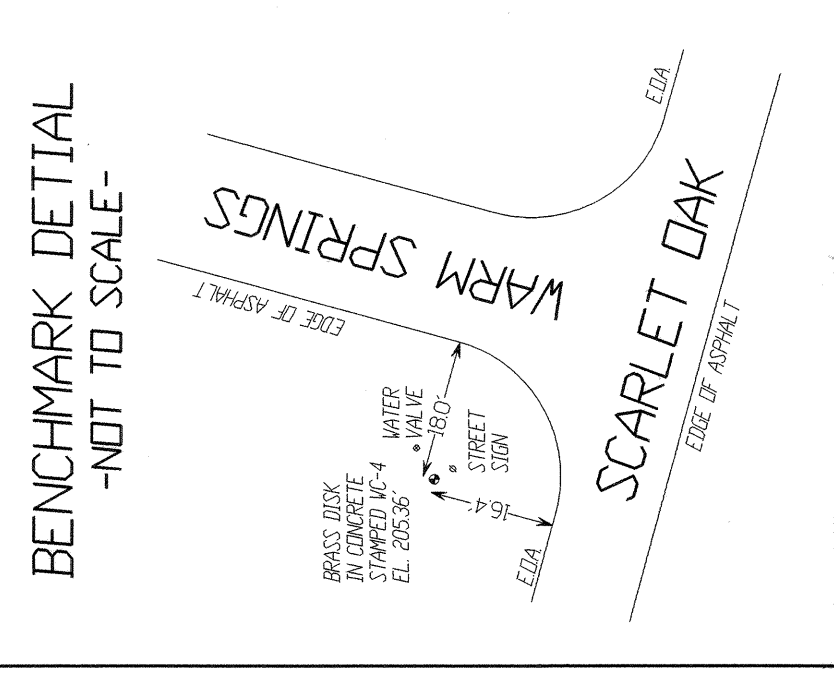
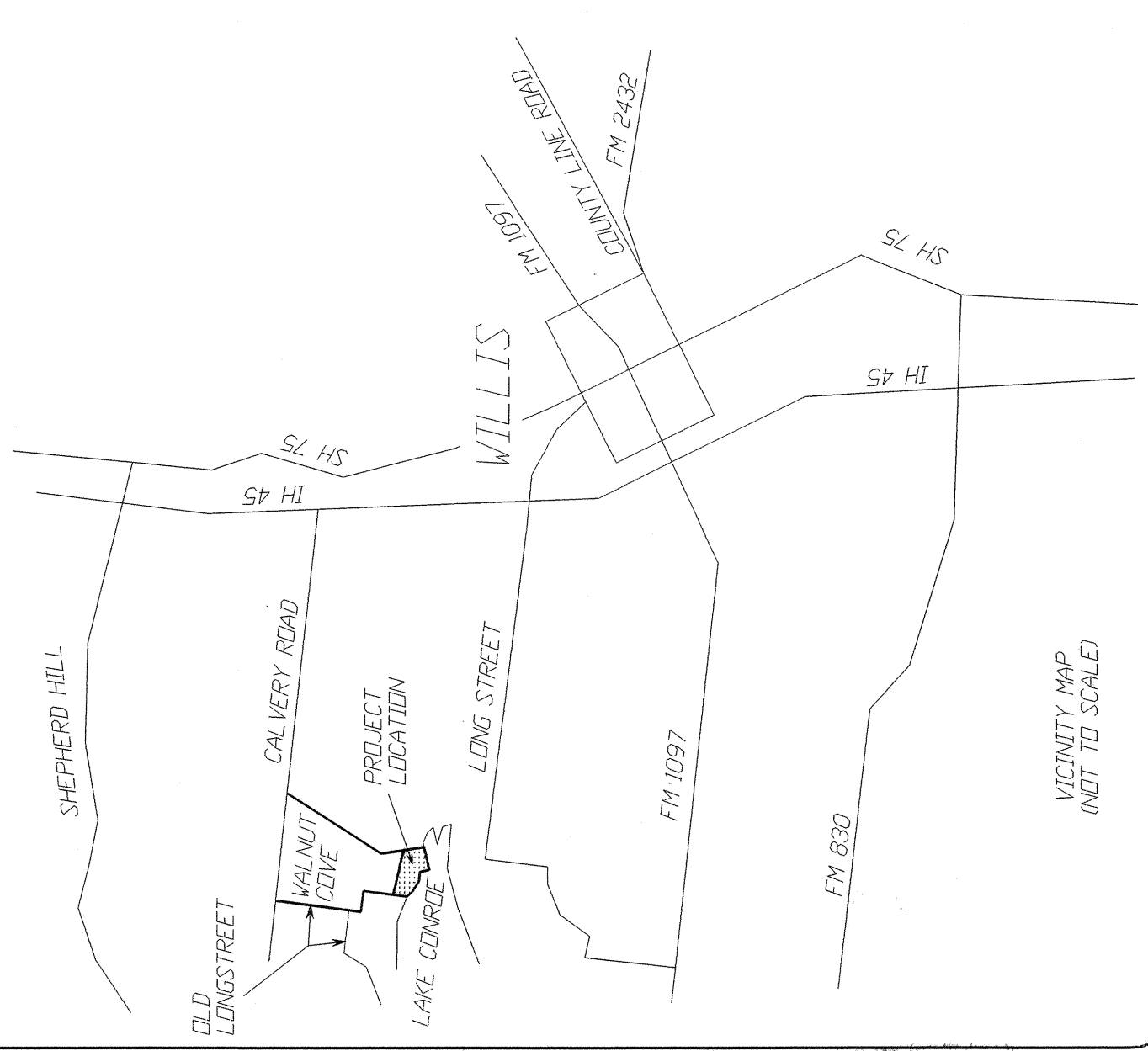

VICINITY MAP (NOT TO SCALE)

LAUGHLIN SURVEYING, INC.  
1300 SOUTH FRAZIER SUITE 301 CONROE TEXAS 77301  
Phone: (936) 788-2244 Fax: (936) 788-2240  
JOB NO. 02-0511-1 July 18, 2002

SHEET 2 OF 2

Walnut Cove Section 4

File # 2004 083956

Cabinet W.

Sheet 10a